

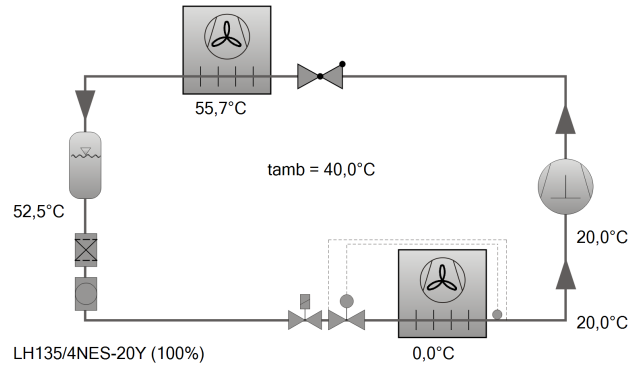

Selection: Condensing Units

Input Values

| | |
|-------------------------|------------------|
| Unit type | (LH135/4NES-20Y) |
| Series | Standard |
| Refrigerant | R404A |
| Reference temperature | Dew point temp. |
| Evaporating SST | 0 °C |
| Ambient temp. | 40,0 °C |
| Suction gas temperature | 20,00 °C |
| Useful superheat | 100% |
| Operating mode | Auto |
| Power supply | 400V-3-50Hz |
| Capacity control | 100% |



Result

| | |
|---------------------|---------------------------|
| Unit type | LH135/4NES-20Y-40P |
| Capacity steps | 100% |
| Cooling capacity | 35,8 kW |
| Evaporator capacity | 35,8 kW |
| Power input | 16,06 kW |
| Current (400V) | 27,2 A |
| Voltage range | 380-420V |
| Mass flow | 1250 kg/h |
| Condensing SDT | 55,7 °C |
| Liquid subcooling | 3,00 K |
| Operating mode | Standard |

According to EU Regulation 517/2014, the refrigerants R404A and R507A are subject to special restrictions of use Tentative Data.
 Since 01.07.2016, available only for regions outside European Union.
 Power input compressor, power input fan see "T. Data"

Application Limits LH135/4NES-20

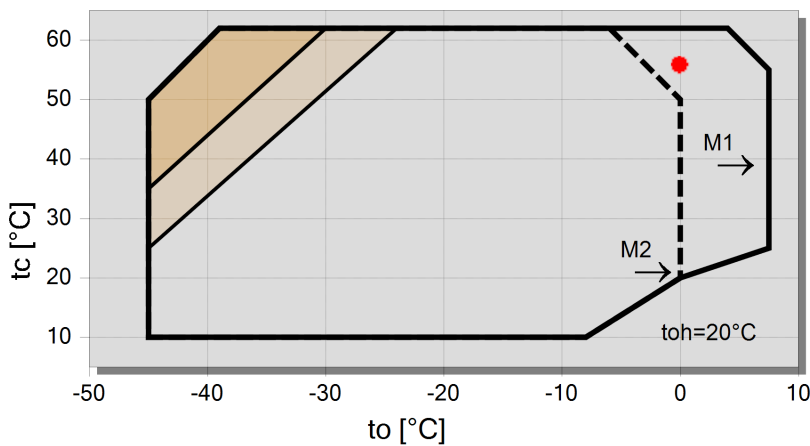

Legend

- additional cooling or suction gas superheat $\leq 20K$
- additional cooling or max. toh $< 0^\circ C$
- M1: motor 1
- M2: motor 2
- A



Technical Data: (LH135/4NES-20Y)

Dimensions and Connections

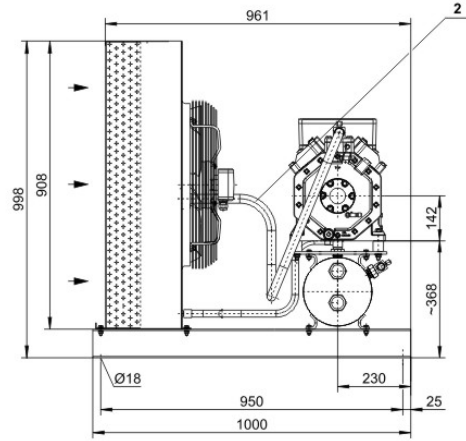
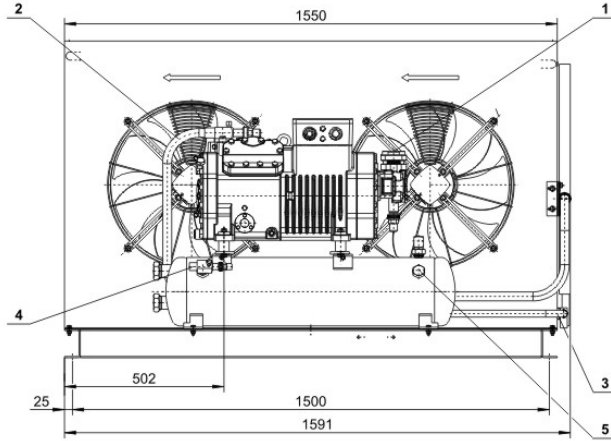



Technical Data

Technical Data

| | |
|--|---------------------------------|
| Weight | 334 kg |
| Total width | 1591 mm |
| Total depth | 1000 mm |
| Total height | 998 mm |
| Connection suction line | 42 mm - 1 5/8" |
| Connection liquid line | 22 mm - 7/8" |
| Voltage (50Hz, more on request) | 230VD / 400VY-3-50Hz (Standard) |
| Current / Power consumption of each fan (50Hz) | 2,80 A 1,62 A / 750 W |
| Air flow condenser 50Hz | 12650 m ³ /h |
| Voltage (60Hz, more on request) | 230VD / 400VY-3-60Hz (Option) |
| Current / Power consumption of each fan (60Hz) | 3,40 A 1,95 A / 1050 W |
| Air flow condenser 60Hz | 13900 m ³ /h |
| Coil Volume | 22,0 dm ³ |

Extent of delivery (standard)

| | |
|--------------------------------------|----------|
| Liquid receiver with shut-off valve | Standard |
| Discharge gas line | Standard |
| Connection for pressure relief valve | Standard |
| Fans: Number | 2 x AC |
| Protective charge | Standard |

Available options

| | |
|--|----------------------------|
| ECOLINE with VARISTEP (CRII) | 100 .. 10% |
| Second capacity regulator (CRII) | Option |
| Condenser with improved corrosion protection, plastic coated fins or copper fins | Option |
| Oil separator with check valve | Option |
| Accessory pack (HP/LP switches, complete wiring, liquid line + filter drier + sight glass) | Option |
| Wiring of electrical components to terminal box or junction box | Option |
| Adjustable high and low pressure switch | Option |
| Speed control fan, control range high pressure | 5 .. 15 bar // 8 .. 25 bar |
| Discharge gas temperature sensor | Option |
| Oil level monitoring | OLC-K1 |
| Oil heater | Option |
| Check valve | Option |
| Weather protective housing, mounting kit | Option |
| Start unloading | Option |
| Oil separator | Option |
| Dressed unit | Option |
| Weather protective housing | Option |

Sound measurement

| | |
|--|-------------------|
| Sound power level (-10°C / 45°C) | 89,0 dB(A) @ 50Hz |
| Sound pressure level @ 1m (-10°C / 45°C) | 81,0 dB(A) @ 50Hz |

Data of compressors: see compressor program

Max. refrigerant charge 90% at 20°C / 68°F

| | |
|--------------------------|---------|
| Receiver type (Standard) | F302H |
| R22 | 32,7 kg |
| R134a | 33,1 kg |
| R407C | 31,3 kg |
| R404A/R507A | 28,8 kg |



Condensing Units

Motor 1 = e.g. LH..E/4TES-12 with 12 "HP", primary for air-conditioning (e.g. R22,R407C) and medium temperature application (e.g. R134a, R407F, R407A, R404A, R507A, R22) and air-conditioning with R134a at high ambient temperatures.

Motor 2 = e.g. LH..E/4TES-9 with 8 "HP", for medium and low temperature application (e.g. R134a, R407F, R407A, R404A, R507A, R22) and air-conditioning with R134a.

For more information concerning the application range use the "limits" button.

Operation modes for LH..E/4VES-7 to LH../6HE-28 with R22

CIC = liquid injection with low temperature application, suction gas cooled motor

Specifications for sound emission

The data are based on 50 Hz operation.

Soundpressure: Data are valid for free field conditions with a block-shaped reference area in a distance of 10m.

For further information see technical information for sound data.